

## Diploma in Civil Engineering (Building and Construction)- Level 7

### Entry Criteria

Applicants must have a Diploma in Civil Engineering (Level 5) or equivalent knowledge and skills.

For international students: IELTS (academic=6.0 score with no band less than 5.5).

### Semester 1

DCE500 Engineering Mathematics

DCE601 Engineering Surveying

DCE701 Structural Systems

### Semester 2

DCE700 Advanced Structural Concrete

DCE702 Geotechnical Earthquake Engineering

DCE706 Construction Management and Economics

### Semester 3

DCE501 Engineering Drawing and Graphics

DCE600 Land Information Systems

DCE705 Building Conservation

### Semester 4

DCE707 Final Project

DCE704 Multi-storey Building Design

DCE703 Timber and Steel Structures

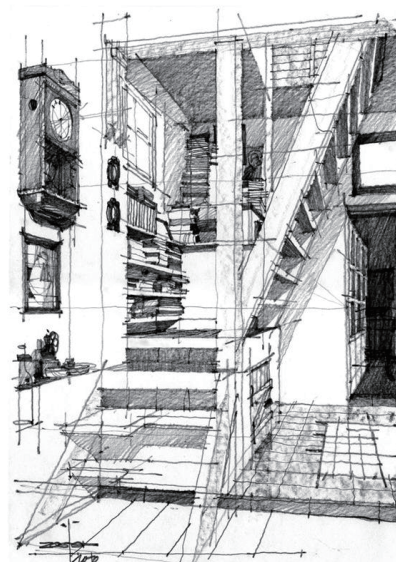

*A scientist can discover a new star but he cannot make one. He would have to ask an engineer to do it for him.*

*- Gordon Lindsay Glegg*



INTERNATIONAL  
COLLEGE of AUCKLAND



Admissions and Fees

Email: [enrol@ica.ac.nz](mailto:enrol@ica.ac.nz), [katie.gao@ica.ac.nz](mailto:katie.gao@ica.ac.nz) Phone: +64 (0)9 309 9558

Technical Enquiries

Email: [faiz@ica.ac.nz](mailto:faiz@ica.ac.nz) Phone: +64 (0)9 309 9558 - ext 115

[www.ica.ac.nz](http://www.ica.ac.nz)

Looking for  
an opportunity to advance  
your career in Civil Engineering?

STUDY **DIPLOMA IN CIVIL ENGINEERING**  
(Building and Construction)-Level 7



INTERNATIONAL  
COLLEGE of AUCKLAND

# STUDY DIPLOMA IN CIVIL ENGINEERING (Building and Construction)-Level 7

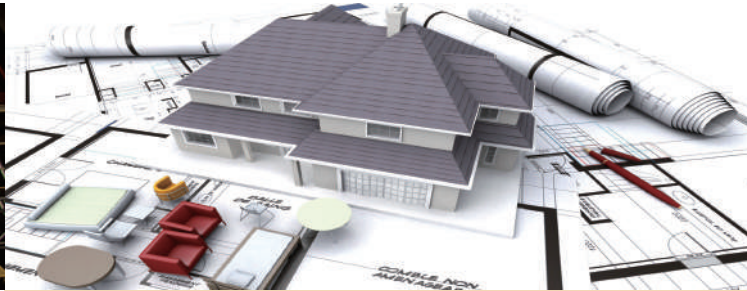

## Civil Engineering- New Zealand

Civil Engineering is one of the oldest engineering discipline and it is responsible for shaping up the modern civilisation with a safe and sustainable built environment to live in. The exciting field of civil engineering covers a broad spectrum of manmade infrastructure including buildings, bridges, roads, dams, airports, railways and subways, water supply and drainage systems. Civil engineers are responsible for planning, designing, organising and overseeing the construction of these facilities. Among different branches of civil engineering, 'Buildings and Construction' is of great importance worldwide and particularly in New Zealand. Building and construction industry is the 3rd largest industry of New Zealand, based on the number of business counts, comprising of 500,000 businesses.

## Diploma in Civil Engineering (Building and Construction)- Level 7

This program is specifically designed to expand knowledge and skills in construction materials theory, contract administration, and project planning, scheduling and costing. If you want to be a part of New Zealand workforce as a Civil Engineer, then Join ICA, the only education provider in New Zealand delivering Diploma in Civil Engineering at level 7.

### Key Features

- NZQA approved qualification
- State of the art laboratories
- Highly qualified faculty
- Flexible class timings
- Recognition of your prior learning up to 50%
- Industry oriented programme

### Intakes

After each 10 weeks

Visit our campus any time between  
9 AM – 7:00 PM Monday to Saturday

### Physical Address

Level 5, 131 Queen Street,  
Auckland CBD,  
New Zealand